

CX2.5/1B

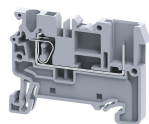

connectwell
THE RIGHT CONNECTION

2.5 sq.mm pluggable feed through Spring Clamp Terminal Block

The Spring Clamp is operated by using a screw driver to provide an access to the wire through an opening in the spring clamp. The inserted wire gets clamped on to the current bar when the screw driver is removed. One side can be plugged with CX2.5PN plugs.

TECHNICAL DATA

Rated Voltage	800 V
Rated Current	24 A
Housing Material	Polymide
Product Function	Feed Through
Wire Entry Orientation	Top
Mounting Possibility	DIN 35/DIN 35-15 Rail
Operated by	Screw Driver
Rated Surge Voltage	8 KV
Pollution Degree	3

CONNECTION DATA

Conductor Cross Section Stranded min.	0.2 mm ²
Conductor Cross Section Stranded max.	2.5 mm ²
Conductor Cross Section AWG/Kcmil min	24 AWG
Conductor Cross Section AWG/Kcmil max	12 AWG
Conductor Cross Section Stranded with Ferrule/Lug min	0.2 mm ²
Conductor Cross Section Stranded with Ferrule/Lug max	2.5 mm ²
Conductor Cross Section Solid min	0.2 mm ²
Conductor Cross Section Solid max	4 mm ²
2 Conductors with same Cross Section Stranded with TWIN Ferrule/Lug min	0.2 mm ²
2 Conductor with same Cross Section Stranded with TWIN Ferrule/Lug max	1.0 mm ²
Stripping Length	8 mm

DIMENSIONS

Height with DIN 35 x 15 mm rail	45.7 mm
Height with DIN 35 x 7.5 mm rail	38.2 mm
Length	50 mm
Width (Thickness)	5 mm

ORDERING INFORMATION

CAT. NO.	DESCRIPTION	STD. PACK
CX2.5/1B	2.5 sq.mm pluggable feed through Spring Clamp Terminal Block	100

ACCESSORIES

IMAGES	CAT. NO.	DESCRIPTION	STD. PACK
	CA701-1M	Din 35 Rail unslotted 1 meter	50

ACCESSORIES

IMAGES	CAT. NO.	DESCRIPTION	STD. PACK
	CA701-2M	Din 35 Rail unslotted 2 meter	50
	CA701-2M-S	Din 35 Rail slotted 2 meter	50
	CA701-1M-S	Din 35 Rail slotted 1 meter	50

	CA701-15-1M	Din 35 Rail 15 deep unslotted 1 meter	50
	CA701-15-1M-S	Din 35 Rail 15 deep slotted 1 meter	50
	CA701-15-2M	Din 35 Rail 15 deep unslotted 2 meter	50
	CA701-15-2M-S	Din 35 Rail 15 deep slotted 2 meter	50

	CA103	EndClamp in Polyamide suitable for Din 35/Din 35-15 rails	50
--	-------	---	----

	CA702	End Clamp in Polyamide 66 suitable for Din 32 / Din 35 / Din 35-15 Rails	50
--	-------	--	----

	CA802	End Clamp in Polyamide suitable for Din 35 / Din 35-15 Rails	50
--	-------	--	----

	EPCX2.5	End Plate in Grey Colour	50
	EPCX2.5BU	End Plate in Blue Colour	50

	JX2.5/2	Shorting Link for 2.5 sq mm series	100
	JX2.5/3	Shorting Link for 2.5 sq mm series	50
	JX2.5/4	Shorting Link for 2.5 sq mm series	50
	JX2.5/5	Shorting Link for 2.5 sq mm series	50
	JX2.5/6	Shorting Link for 2.5 sq mm series	50
	JX2.5/7	Shorting Link for 2.5 sq mm series	10
	JX2.5/8	Shorting Link for 2.5 sq mm series	10
	JX2.5/10	Shorting Link for 2.5 sq mm series	10
	JX2.5/20	Shorting Link for 2.5 sq.mm series	10

	CA509/K5	Blank Marking Tag	100
--	----------	-------------------	-----

	WLX2.5	Warning label suitable for 5mm wide terminal block	50
--	--------	--	----

	SCS0.5/3	Electricians Screwdriver for slotted screws	10
--	----------	---	----

	CXPOLN	Coding Pin	25
--	--------	------------	----

CX2.5/1B

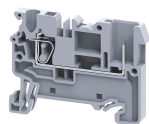

connectwell
THE RIGHT CONNECTION

ACCESSORIES

IMAGES	CAT. NO.	DESCRIPTION	STD. PACK
	CX2.5PN	2.5 mm ² 1 POLE PLUG SPRING CLAMP TB	100
	CX2.5PNBU	2.5 mm ² 1 POLE PLUG SPRING CLAMP TB IN BLUE COLOR	100
	CX2.5PNYG	2.5 mm ² 1 POLE PLUG SPRING CLAMP TB IN YELLOW GREEN COLOR	100
	CX2.5PLN	2.5 mm ² 1 POLE PLUG SP CL STACK END TB	100
	CX2.5PN/2	2.5 mm ² 2 POLE PLUG SPRING CLAMP TB	100
	CX2.5PN/3	2.5 mm ² 3 POLE PLUG SPRING CLAMP TB	100
	CX2.5PN/4	2.5 mm ² 4 POLE PLUG SPRING CLAMP TB	100
	CX2.5PN/5	2.5 mm ² 5 POLE PLUG SPRING CLAMP TB	100
	CX2.5PN/6	2.5 mm ² 6 POLE PLUG SPRING CLAMP TB	25
	CX2.5PN/7	2.5 mm ² 7 POLE PLUG SPRING CLAMP TB	25
	CX2.5PN/8	2.5 mm ² 8 POLE PLUG SPRING CLAMP TB	25
	CX2.5PN/9	2.5 mm ² 9 POLE PLUG SPRING CLAMP TB	25
	CX2.5PN/10	2.5 mm ² 10 POLE PLUG SPRING CLAMP TB	25
	CX2.5PN/11	2.5 mm ² 11 POLE PLUG SPRING CLAMP TB	10
	CX2.5PN/12	2.5 mm ² 12 POLE PLUG SPRING CLAMP TB	10
CX2.5PN/13	2.5 mm ² 13 POLE PLUG SPRING CLAMP TB	10	
CX2.5PN/14	2.5 mm ² 14 POLE PLUG SPRING CLAMP TB	10	
CX2.5PN/15	2.5 mm ² 15 POLE PLUG SPRING CLAMP TB	10	

	CXLPN	Locking Pin for CX2.5PN/CX2.5SN	25
--	-------	---------------------------------	----

	MC5	MARKER CARD 5MM PITCH WITH 84 TAGS	10
--	-----	------------------------------------	----

APPROVALS



NOTES

The Rated current is with the use of copper (Cu) conductor/Wire

RATINGS AS PER STANDARDS

STANDARDS	UL 1059	CSA C.22.2 No:158	IEC/EN60947-7-1
Approvals	UL	CSA	CE

CX2.5/1B

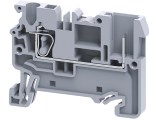

connectwell
THE RIGHT CONNECTION

RATINGS AS PER STANDARDS

Conductor Cross Section Stranded min.	24 AWG	24 AWG	0.2 mm ²
Conductor Cross Section Stranded max.	12 AWG	12 AWG	2.5 mm ²
Rated Voltage	300 V	300 V	800 V
Rated Current	20 A	20 A	24 A